

## Swivels

Our Johnson thrust bearing swivels are widely used for the primary purpose of allowing the natural twist in wire rope to rotate as necessary without affecting the suspended load. Standard swivels are available in six different end fitting combinations, from 3 to 30 metric tonnes WLL.

Simple and compact, the swivels are engineered for long life and economical cost. Hooks are forged alloy steel, lubrication fittings are recessed, and a generous bronze bushing assures toughness and long life.



### Standard Equipment

- Forged hook with latch
- Roller thrust bearing
- Large bronze thrust bushing
- Recessed lubrication fitting
- Large lubricant reservoir
- Proof load test

### Optional Equipment

- Custom end fitting sizes
- Custom sizes above 30 metric tonnes WLL
- Anti-corrosion coatings
- CE compliant upon request.

## The Simple and Compact Design of a Johnson Swivel

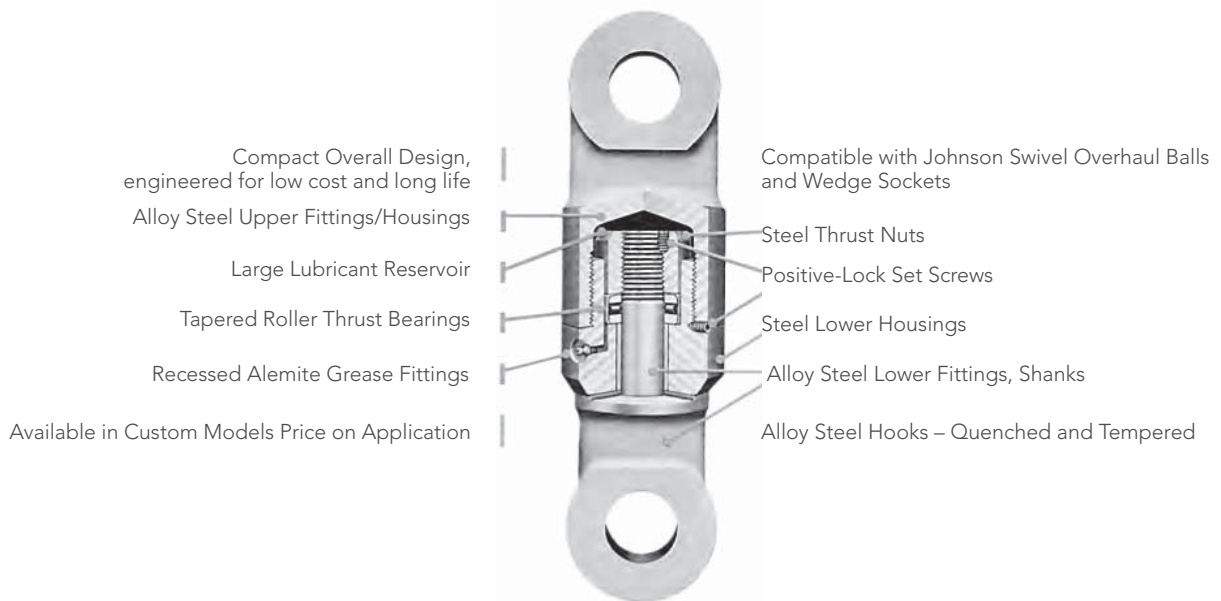

## Swivel Eye/Hook, 3 - 30 metric tonnes

Design Factor - see table

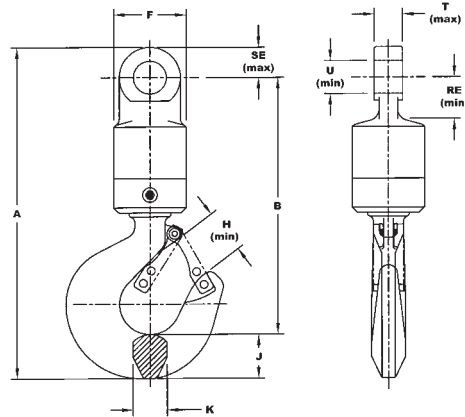

Key to Eye/Hook Swivel Model Numbers:

- 3 - Working Load Limit (metric tonnes)
- E - Top Fitting (E = Eye)
- H - Bottom Fitting (H = Hook)
- M - Midget Swivel

To order please specify the model number.

Art.no.	Model No.	WLL metric tonnes	A Overall Length	B Net Length	F Swivel Dia.	H Throat Opening with Latch	J Hook Thickness	K Hook Width	RE Hole to Obstruction Min	SE Hole to End of Fitting Max	T Thickness of Eye Max	U Hole Dia. Min	Weight lb	Design Factor
471266	3EHM	3	10.58	7.91	2.63	1.12	1.48	1.12	1.23	1.22	0.91	1.03	8	5
471268	3EH	3	13.46	10.73	3.25	1.12	1.48	1.12	1.56	1.34	1.03	1.31	15	5
471270	5EH	5	13.79	11.06	3.25	1.12	1.48	1.12	1.55	1.34	1.03	1.30	15	4
471272	7EH	7	14.82	11.76	3.25	1.39	1.81	1.38	1.55	1.34	1.03	1.31	16	4
471274	9EH	9	18.56	14.03	4.00	1.91	2.53	1.93	2.24	2.03	1.28	1.78	34	4
471276	12EH	12	18.89	14.36	4.44	1.91	2.53	1.93	2.43	2.03	1.28	1.78	39	4
471278	15EH	15	18.89	14.36	4.44	1.91	2.53	1.93	2.43	2.03	1.28	1.78	39	4
471280	20EH	20	22.83	17.45	5.25	2.80	3.00	2.38	2.78	2.50	1.66	2.10	69	4
471281	25EH	25	24.78	18.90	5.25	3.28	3.50	3.00	2.78	2.50	1.66	2.10	90	5
471282	30EH	30	26.53	20.28	6.50	3.28	3.50	3.00	2.79	2.88	1.63	2.32	117	4

## Swivel Jaw/Hook, 3 - 15 metric tonnes

Design Factor - see table

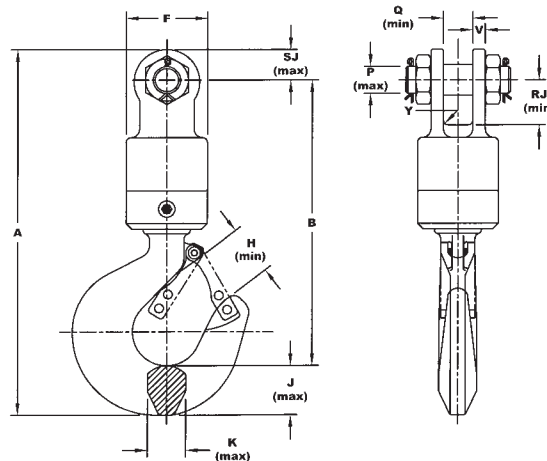

Key to Jaw/Hook Swivel Model Numbers:

- 3 - Working Load Limit (metric tonnes)
- J - Top Fitting (J = Jaw)
- H - Bottom Fitting (H = Hook)
- M - Midget Swivel

To order please specify the model number.

Art.no.	Model No.	WLL metric tonnes	A Overall Length	B Net Length	F Swivel Dia.	H Throat Opening with Latch	J Hook Thickness	K Hook Width	P Pin Dia. Max	Q Width Between Ears Min	RJ Pin to Obstruction Min	SJ Pin to End of Fitting Max	V Thickness of Ear	Y Jaw Radius	Weight lb	Design Factor
471267	3JHM	3	10.52	7.91	2.63	1.12	1.48	1.12	1.00	0.97	1.08	1.22	0.50	0.09	8.60	5
471269	3JH	3	13.71	10.85	3.25	1.12	1.48	1.12	1.25	1.44	2.07	1.43	0.56	0.25	18.08	5
471271	5JH	5	14.04	11.18	3.25	1.12	1.48	1.12	1.25	1.44	2.07	1.43	0.56	0.25	18.96	4
471273	7JH	7	15.07	11.89	3.25	1.39	1.81	1.38	1.25	1.44	2.07	1.43	0.56	0.25	19.84	4
471275	9JH	9	18.62	14.09	4.00	1.91	2.53	1.93	1.75	1.69	2.69	2.06	0.75	0.25	39.90	5
471277	12JH	12	19.14	14.61	4.44	1.91	2.53	1.93	1.75	1.94	2.94	2.06	0.75	0.25	44.97	4
471279	15JH	15	19.14	14.61	4.44	1.91	2.53	1.93	1.75	1.94	2.94	2.06	0.75	0.25	44.97	4

## Swivel Eye/Eye, 3 - 30 metric tonnes

Design Factor 5:1, CE marked

### Key to Eye/Eye Swivel Model Numbers:

- 3 - Working Load Limit (metric tonnes)
- E - Top Fitting (E = Eye)
- E - Bottom Fitting (E = Eye)
- M - Midget Swivel

To order please specify the model number.

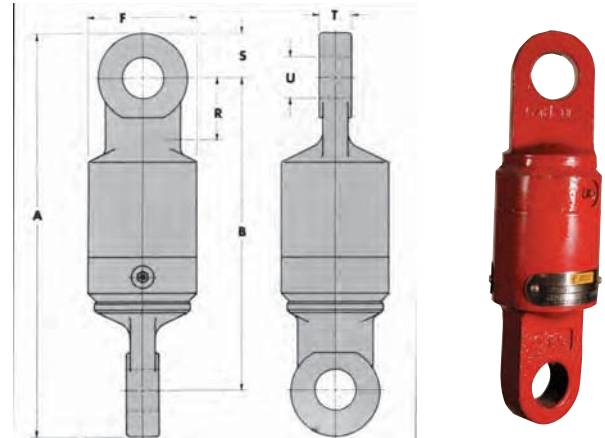

Art.no.	Model No.	WLL metric tonnes	A Overall Length	B Net Length	F Swivel Dia.	R Hole to Obstruction Min	S Hole to End of Fitting Max	T Thickness of Eye Max	U Hole Dia. Min	Weight lb
471430	3EEM	3	8.03	5.65	2.63	1.25	1.25	0.91	1.03	6
471769	4EE	4	12.03	9.47	3.25	1.55	1.34	1.03	1.31	14
471434	7EE	7	11.90	9.34	3.25	1.55	1.34	1.03	1.31	14
471438	12EE	12	15.29	11.29	4.00	2.42	2.03	1.28	1.78	26
471442	19EE	19	15.90	11.90	4.44	2.47	2.03	1.28	1.78	32
471446	25EE	25	17.70	12.95	5.25	2.79	2.41	1.66	2.10	50
471447	30EE	30	20.21	14.71	6.50	2.60	2.78	1.63	2.31	85

## Swivel Jaw/Jaw, 3 - 19 metric tonnes

Design Factor 5:1, CE marked

### Key to Jaw/Jaw Swivel Model Numbers:

- 3 - Working Load Limit (metric tonnes)
- J - Top Fitting (J = Jaw)
- J - Bottom Fitting (J = Jaw)
- M - Midget Swivel.

To order please specify the model number.

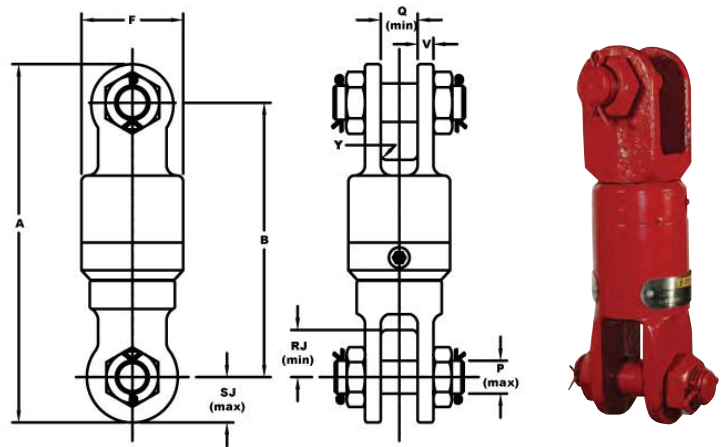

Art.no.	Model No.	WLL metric tonnes	A Overall Length	B Net Length	F Swivel Dia.	P Pin Dia. Max	Q Width Between Ears Min	R Pin to Obstruction Min	S Pin to End of Fitting Max	V Thickness of Ear	Y Jaw Radius	Weight lb
471433	3JJM	3	8.21	5.89	2.63	1.00	0.97	1.32	1.25	0.50	0.09	8
471772	4JJ	4	12.48	9.71	3.25	1.25	1.44	2.07	1.44	0.56	0.25	22
471437	7JJ	7	12.48	9.71	3.25	1.25	1.44	2.07	1.44	0.56	0.25	22
471441	12JJ	12	15.61	11.61	4.00	1.75	1.69	2.69	2.06	0.75	0.25	42
471445	19JJ	19	16.64	12.64	4.44	1.75	1.94	2.94	2.06	0.75	0.25	47

## Swivel Jaw/Eye, 3 - 19 metric tonnes

Design Factor 5:1, CE marked

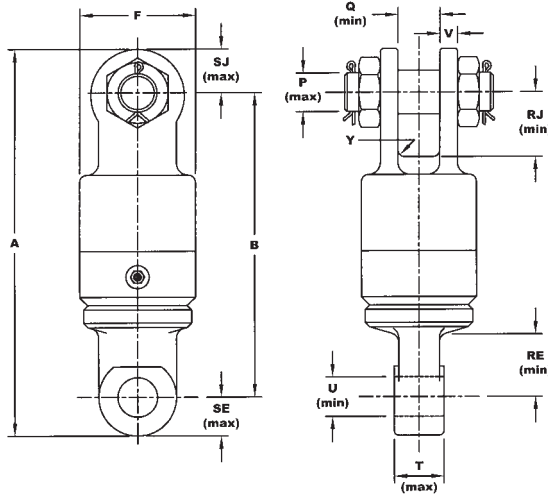

### Key to Jaw/Eye Swivel Model Numbers:

- 3 - Working Load Limit (metric tonnes)
- J - Top Fitting (J = Jaw)
- E - Bottom Fitting (E = Eye)
- M - Midget Swivel

To order please specify the model number.

Art.no.	Model No.	WLL metric tonnes	A Overall Length	B Net Length	F Swivel Dia.	P Pin Dia. Max.	Q Width Between Ears Min.	RE Hole to Obstruction Min.	RJ Pin to Obstruction Min.	SE Hole to End of Fitting Max.	SJ Pin to End of Fitting Max.	T Thickness of Eye Max.	U Hole Dia. of Fitting Min.	V Thickness of Ear	Y Jaw Radius	Weight lb
471432	3JEM	3	7.96	5.65	2.63	1.00	0.94	1.32	1.32	1.25	1.22	0.93	1.03	0.50	0.09	7
471771	4JE	4	12.15	9.45	3.25	1.25	1.44	1.55	2.07	1.40	1.37	0.94	1.31	0.56	0.25	17
471436	7JE	7	12.28	9.50	3.25	1.25	1.44	1.55	2.12	1.37	1.38	1.00	1.25	0.56	0.25	17
471440	12JE	12	15.54	11.54	4.00	1.75	1.72	2.43	2.72	2.03	2.03	1.28	1.78	0.75	0.25	33
471444	19JE	19	15.90	11.90	4.44	1.75	1.97	2.43	2.97	2.03	2.03	1.28	1.78	0.75	0.25	38

## Swivel Eye/Jaw, 3 - 19 metric tonnes

Design Factor 5:1, CE marked

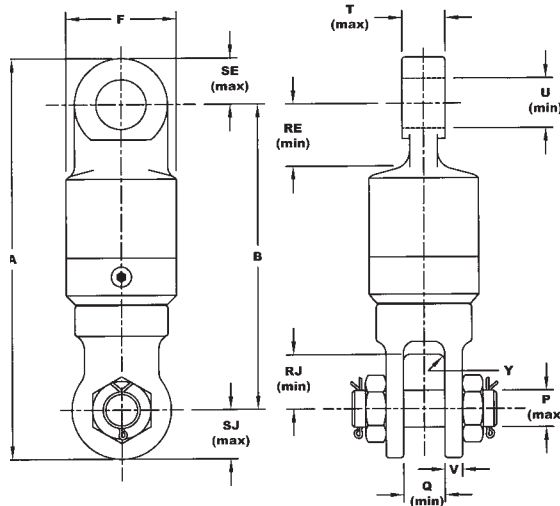

### Key to Eye/Jaw Swivel Model Numbers:

- 3 - Working Load Limit (metric tonnes)
- E - Top Fitting (E = Eye)
- J - Bottom Fitting (J = Jaw)
- M - Midget Swivel

To order please specify the model number.

Art.no.	Model No.	WLL metric tonnes	A Overall Length	B Net Length	F Swivel Dia.	P Pin Dia. Max.	Q Width Between Ears Min.	RE Hole to Obstruction Min.	RJ Pin to Obstruction Min.	SE Hole to End of Fitting Max.	SJ Pin to End of Fitting Max.	T Thickness of Eye Max.	U Hole Dia. Min.	V Thickness of Ear	Y Jaw Radius	Weight lb
471431	3EJM	3	8.27	5.90	2.63	1.00	0.97	1.25	1.35	1.22	1.22	0.91	1.03	0.50	0.09	7.28
471770	4EJ	4	12.23	9.59	3.25	1.25	1.44	1.63	2.07	1.28	1.44	1.03	1.31	0.56	0.25	18.08
471435	7EJ	7	12.23	9.59	3.25	1.25	1.44	1.63	2.07	1.28	1.44	1.03	1.31	0.56	0.25	18.08
471439	12EJ	12	15.61	11.61	4.00	1.75	1.69	2.53	2.69	2.03	2.06	1.28	1.78	0.75	0.25	35.05
471443	19EJ	19	16.39	12.39	4.44	1.75	1.94	2.44	2.94	2.03	2.06	1.28	1.78	0.75	0.25	42.11